

Riverside

TOOL CORP.

Saw Blade Tooth Designs

An informational sheet for identification and recommendations.
All data listed here is general and may not be specific to your situation.
Information is provided as a reference and may vary per application.

FTG
(Flat Top Grind)

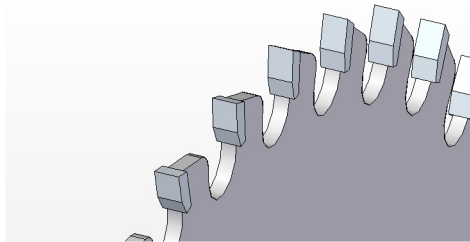

For cutting natural wood with the grain. Used on multiprip saw blades, saw blades for portable machines and universal saw blades.

ATB
(Alternate Top Bevel)

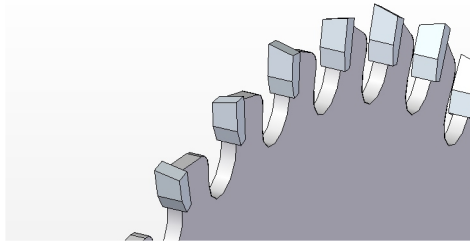

Most common design. Excellent for cutting with or against the grain. Works well in many different applications. Typical for cross grain, but also used on ripping blades.

ATB+R
(Alternate Top Bevel plus Raker)

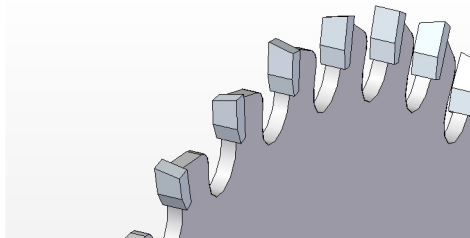

For cut-off or trimming. The flat top raker sits lower in the cut. The raker aids by cleaning out the cut and improving chip ejection.

TCG
(Triple Chip Grind)

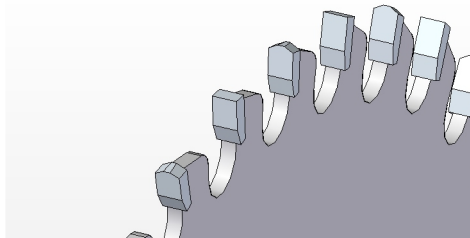

This type of design is typically used for longer life and when cutting abrasive or hard materials or Non Ferrous metals. May also be used for ripping with the appropriate hook angle and design.

Conic
(Score)

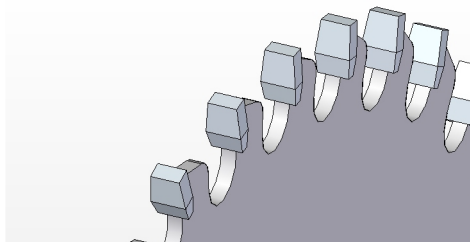

Tapered sides allow cutting kerf to be adjusted by adjusting the cutting height of the blade. Normally used in conjunction with a main panel saw.

Saw Blade Tooth Designs Cont.

Conic ATB (Score)

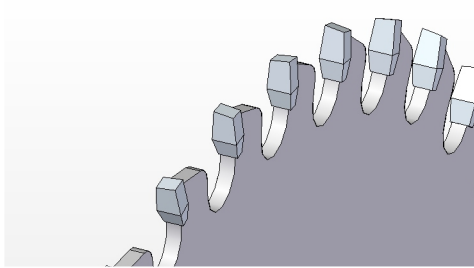

Same as a flat top conic, but with alternate top bevel. Used to score more sensitive material.

Hi ATB (Hi Alternate Top Bevel)

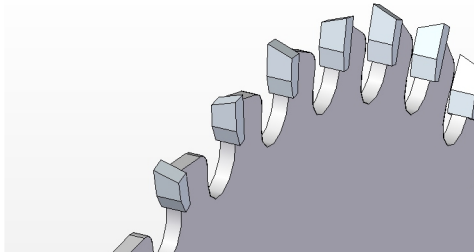

Same as regular ATB only with a higher top bevel angle. Used for melamine, formica, and fine plywood. Generally used with a non-aggressive hook angle.

CTC (California Triple Chip)

Modified TCG (Modified Triple Chip)

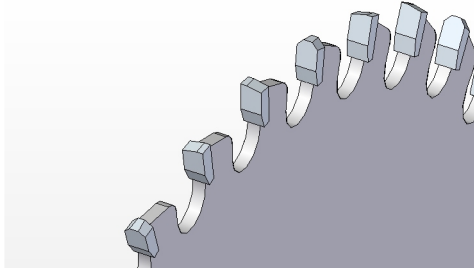

Used to cut a variety of materials without changing blades. Commonly used for mild steel cutting and Non-Ferrous.

TC2

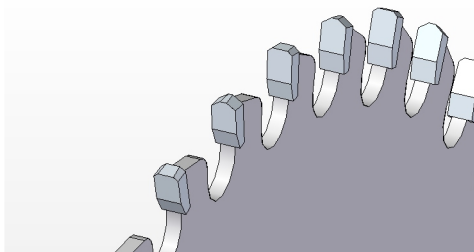

Used in solid surface or plastics and Non-Ferrous

HF (Hollow Face)

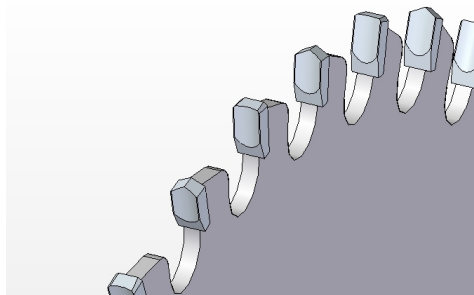

Used in applications with sensitive material such as laminates or veneers. Generally this can cut sensitive materials without a scoring blade.

ATB+R WITH SHEER

ATAF (Alternating Top Alternating Face)

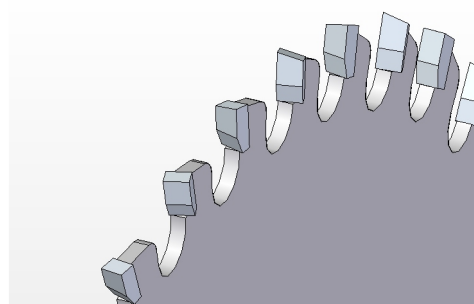

Used in applications with sensitive material. Also used in Mitre Saws and Vertical Panel Saws.